

# Champagne Morning - 2005 Genesis 70ft



## **Location**

Waterway Houseboat Vacations  
#10 Mervyn Road  
Sicamous, British Columbia

## **Contact**

Colleen Anderson/Sales Manager  
Email: [canderson@waterwayhouseboats.com](mailto:canderson@waterwayhouseboats.com)  
Cell Phone: (250) 833-5288  
Office Phone: (250) 836-4566  
Waterway's Office Fax: (250) 836-3032



Canada's best houseboating™

# Champagne Morning - 2005 Genesis 70ft

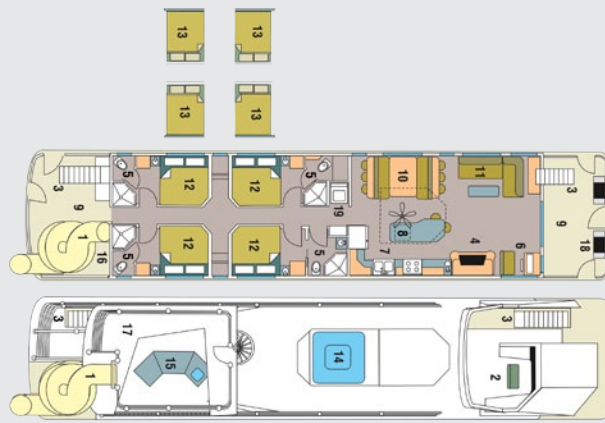

## Floor Plan

- |                                       |                                  |
|---------------------------------------|----------------------------------|
| 1. Tube Slide                         | 10. Dinette Double Sleeping area |
| 2. Upper Command Bridge               | 11. California King Bed          |
| 3. Front/Back Outer Stair Access      | 12. King Private sleeping area   |
| 4. Fireplace and Entertainment Centre | 13. Queen Private sleeping area  |
| 5. 3 Piece Bath                       | 14. Hot Tub                      |
| 6. Helm                               | 15. Wet Bar                      |
| 7. Galley                             | 16. Rear Deck Shower             |
| 8. Dishwasher                         | 17. Third level observation Deck |
| 9. Front & back Deck                  | 18. Propane BBQ                  |
|                                       | 19. Washer/Dryer                 |

## Standard Features on the Genesis 70

- |                  |                                   |
|------------------|-----------------------------------|
| • Railings       | • 4 Full Private Heads            |
| • Swim Ladder    | • 4 King Size Private State Rooms |
| • Tubeslide      | • 4 Queen cuddy Rooms             |
| • Upper Steering | • 2 Gas BBQ                       |
| • Full Galley    | • Bimini Top                      |

## Outstanding Additional Features

- 16' X 70' 20 Sleeper
- Entertainment center • Fireplace • AM / FM 5.1 Surround Sound Stereo
  - CD Player / TV / DVD Player / Satellite Receiver & Dish
  - Large Counters, Drawers & Cupboards • Fully Equipped Galley
  - Granite Island • Refrigerator / Range / Microwave Oven
  - Wet Bar w/bar fridge • Flying Bridge • 3rd level Observation Deck
  - Central Ducted Heat and Air Conditioning

## Specifications

Houseboat Name: Champagne Morning  
 Houseboat Make: Waterways Builders  
 Model Year: 2005  
 Dimensions: 16' X 70'  
 Cabin: 50' 8"  
 Front Deck: 8' 4"  
 Rear Deck: 10' 10"  
 Ceiling Height: 7' 1"  
 Capacity: 20 People  
 Fuel Capacity: 725 LTRS.  
 Draft: 2'1"  
 Dead rise: 2'5-3/8"  
 Weight: 49,628 lbs  
 Water Capacity: 55 Gallons  
 Fuel Capacity: 160 Gallons  
 Propane Capacity: 57 Gallons

## Power

Engine: Mercruiser Bravo II Drive  
 Type: 4. 3 LTR 6 CYL. 181 CID.  
 Horse Power: 135 Horse 4400-4800 RPM  
 Fuel System: Carbureted  
 Lubrication: 4 Cycle, 25W40 Marine Oil  
 Engine Protection: Engine overheat, Low oil level, Low Drive oil Level

## Corrosion Protection

Magnesium Sacrificial Anodes to Hull

## House Power

24 Volt Lighting Through Out  
 4 X 12 Volt AGM Batteries  
 2 X 12 Volt Starting Batteries  
 Westerbeke 12.5 generator  
 Fuel injected safe co gasoline generator.  
 Magnum Pro Sign Inverter (For 110V)

## Cost

\$325,000.00 (Canadian Funds)

## Location

Waterway Houseboat Vacations  
 #10 Mervyn Road  
 Sicamous, British Columbia

## Contact

Colleen Anderson/Sales Manager  
 Email: canderson@waterwayhouseboats.com  
 Cell Phone: (250) 833-5288  
 Office Phone: (250) 836-4566  
 Waterway's Office Fax: (250) 836-3032



Canada's best houseboating™